

PENETRON 1.4kg./sq.m.  
applied by brush or spray.

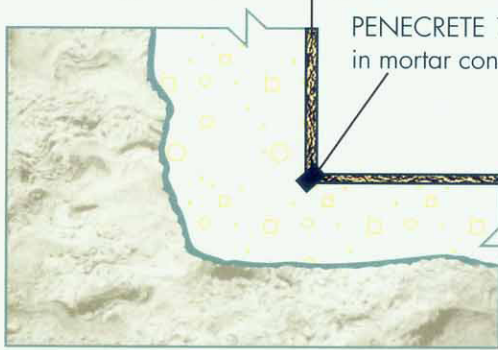

PENECRETE 1.1kg.-1.6kg./lin.m.  
in mortar consistency.

PENETRON 1.4kg./sq.m.

OR

PENETRON PLUS 0.5-  
0.7kg./sq.m. applied in  
powder consistency during  
finishing of concrete.

PENETRON 1.4kg./sq.m.  
applied by brush or spray  
equipment.

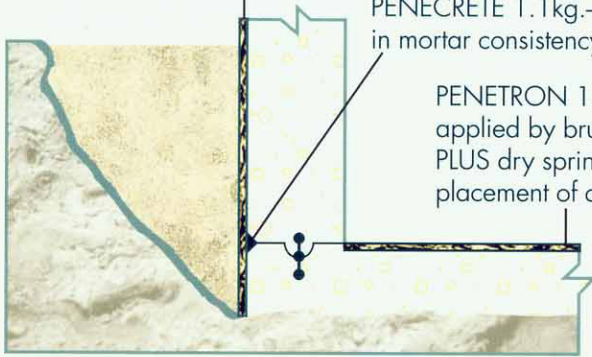

PENECRETE 1.1kg.-1.6kg./lin.m.  
in mortar consistency.

PENETRON 1.4kg./sq.m.  
applied by brush or PENETRON  
PLUS dry sprinkled during  
placement of concrete.

PENETRON applied in 2  
coats.  
1.4kg./sq.m.

PENETRON PLUS 0.5kg./  
sq.m. dry-shaken and  
trowel applied

OR

PENETRON 1.4kg./sq.m.  
applied in 1 coat.

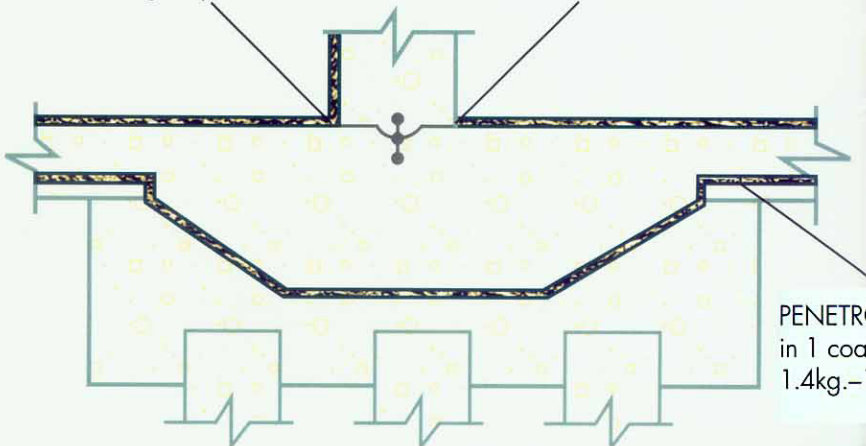

PENETRON applied  
in 1 coat.  
1.4kg.-1.6kg./sq.m.